

Kimbark & 11th Street Properties Downtown Longmont Spaces for Lease

RETAIL, OFFICE & FLEX UNITS AVAILABLE

Sizes: 1,000-2,550 SF

Rate: \$15.00 NNN (\$5.25)

Available Now

HEART OF LONGMONT

Whether you're looking for retail, office, or a combination of both, these flexible 1,000-2,000 SF spaces in the heart of Longmont are exactly what your business needs! Located on the corner of Kimbark and 11th St, just across from the picturesque Athletic Field Park, you're right where all the action happens. With Main Street just around the corner, you'll be surrounded by restaurants, shopping, and green spaces—all of which contribute to a vibrant, thriving atmosphere that draws foot traffic and fosters community connections. Your future customers are just a few steps away from your door. Imagine your brand flourishing in this high-traffic, accessible location that combines visibility with a welcoming, local vibe.

PROPERTY HIGHLIGHTS

- High traffic downtown location
- Walkable to the Kitley neighborhood
- Located in central Longmont along Main Street
- Affordable / flexible layout
- A variety of uses allowed in this mixed use zoning (MU-C)



LEARN MORE ABOUT THIS PROPERTY
[MarketRealEstate.com](https://www.MarketRealEstate.com)

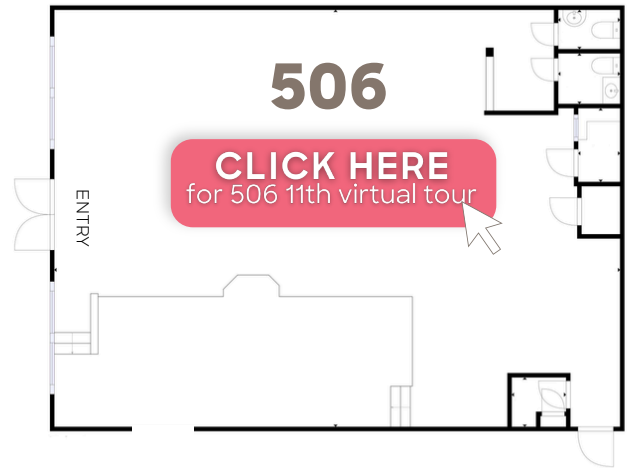

TODD WALSH, CCIM

303 444 5040

Todd@MarketBoulder.com

LEARN MORE ABOUT THIS PROPERTY
MarketRealEstate.com