

Flex Suite For Lease In East Boulder

1930 CENTRAL AVE | BOULDER, CO 80301
SUITE B

Size: 2,246 SF
Rate: \$15.00 NNN (\$6.28)
Available Now

LEAVE YOUR MARK

Like a blank canvas to an artist or a blank page to a poet, there is endless potential for your business in this flex space. Think of the white walls as permission to make it your own, and then get a load of this: the building's owner is in the process of evaluating a full remodel that would lose the drop ceiling to create an open, modern look and feel. From there, what happens within these walls is up to you.

PROPERTY HIGHLIGHTS

- Move-in ready or potential for remodel
- Flexible floor plan
- Surrounded by food, coffee and brewery options
- Convenient Flatiron Park location in East Boulder



LEARN MORE ABOUT THIS PROPERTY
MarketBoulder.com

market

REAL ESTATE

DISCLAIMER: The information contained herein has been obtained from sources believed to be reliable. While we do not doubt its accuracy, we have not verified it and make no guarantee, warranty or representation about it. It is your responsibility to independently confirm its accuracy and completeness.

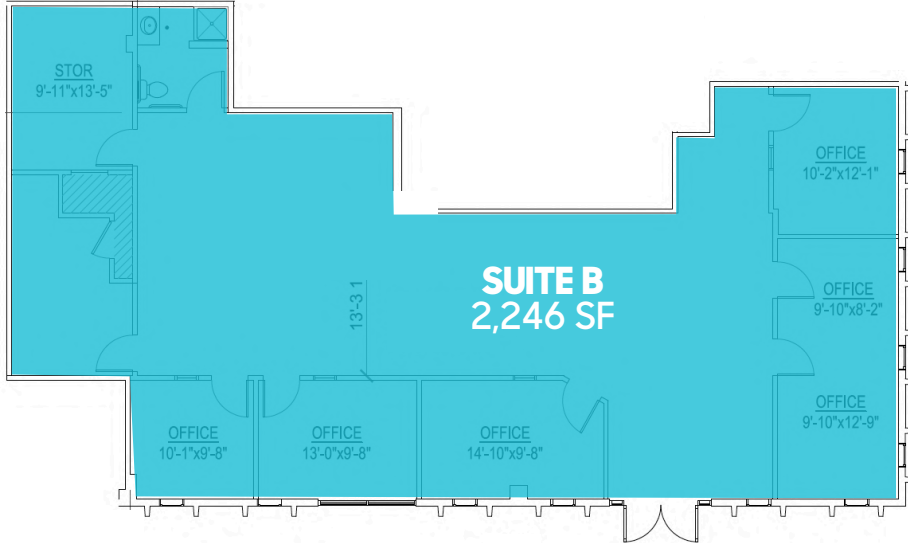

LEARN MORE ABOUT THIS PROPERTY
MarketBoulder.com

TODD WALSH, CCIM
 303 444 4888 Todd@MarketBoulder.com

NATE LITSEY
 303 444 4024 Nate@MarketBoulder.com

